

0.83in [21mm]
(MAX INTONATION)

0.48in [12mm]
(MIN INTONATION)

0.63in [16mm]
(MAX STRING HEIGHT)

0.787in [20.0mm]
±.062in [1.5mm]
(STRING SPACING)

0.40in [10mm]
(MIN STRING HEIGHT)

QUICK RELEASE CHANNELS

1.685in [42.8mm]

1.251in [31.8mm]

4.155in [105.5mm]

2.000in [50.8mm]

1.574in [40.0mm]

1.574in [40.0mm]

R0.125in [3.2mm]

WEIGHT (WITH MOUNTING HARDWARE):
ALUM: 5.9oz [167g] **BRASS:** 11.6oz [329g]

THIS DRAWING IS THE SOLE PROPERTY OF HIPSHOT PRODUCTS, INC. ALL RIGHTS ARE RESERVED. DIMENSIONS AND PRODUCT FEATURES MAY CHANGE WITHOUT NOTICE.

UNLESS OTHERWISE SPECIFIED: DIMENSIONS ARE IN INCHES TOLERANCE: ± .005

REV DATE:
4/11/2021

5A500-787 5 STG A STYLE
BASS BRIDGE .787 SPACING
DIMENSIONS



8248 STATE ROUTE 96
Interlaken, NY 14847 U.S.A.
TEL: 607-532-9404 FAX: 607-532-9530
E-MAIL: info@HipshotProducts.com

Scale

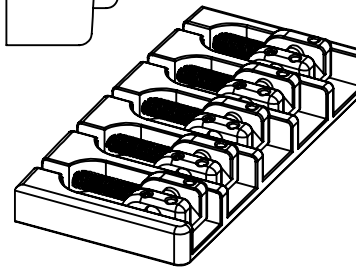
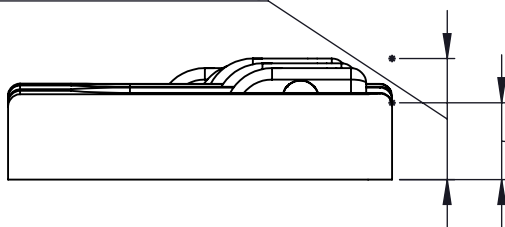
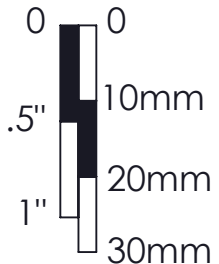

A

A

ϕ

ϕ

B

B