

0.96in [24mm]  
MAX INTONATION)

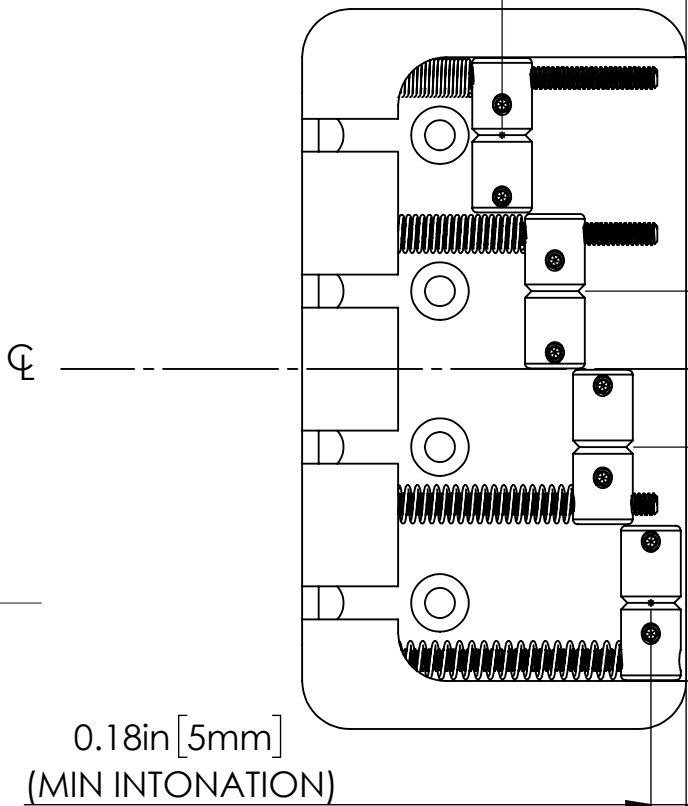

**DISCONTINUED IN 2022**

3.750in [95.3mm]

R0.250in [6.4mm]

2.000in [50.8mm]  
1.283in [32.6mm]

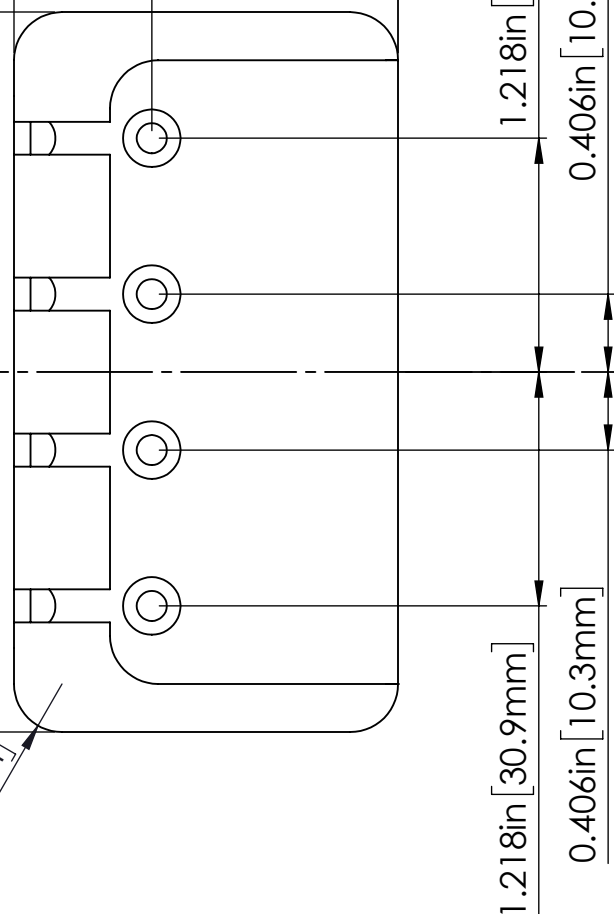

0.18in [5mm]  
(MIN INTONATION)

0.812in [20.6mm]  
(STRING SPACING)

0.68in [17mm]  
(MAX STRING HEIGHT)

0.39in [10mm]  
(MIN STRING HEIGHT)

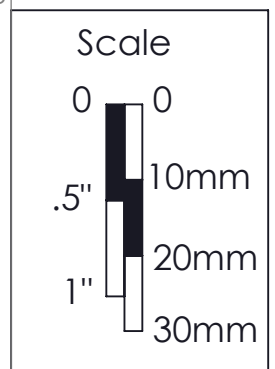
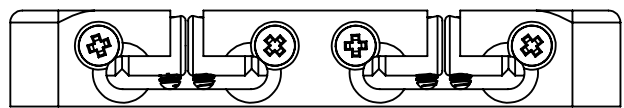

WEIGHT (WITH MOUNTING HARDWARE):  
**ALUM:** 3.9oz [110g] **BRASS:** 8.6oz [243g]

THIS DRAWING IS THE SOLE PROPERTY OF HIPSHOT PRODUCTS, INC. ALL RIGHTS ARE RESERVED. DIMENSIONS AND PRODUCT FEATURES MAY CHANGE WITHOUT NOTICE.

UNLESS OTHERWISE SPECIFIED: DIMENSIONS ARE IN INCHES TOLERANCE: ± .005

REV DATE:  
2/28/2021

**5B400-812 4 STG B STYLE BASS  
BRIDGE .812 SPACING  
DIMENSIONS**



8248 STATE ROUTE 96  
Interlaken, NY 14847 U.S.A.  
TEL: 607-532-9404 FAX: 607-532-9530  
E-MAIL: info@HipshotProducts.com